

Supervision & Project Management Portfolio

**Assuring Codes
& Keen Design**

Since 2004

www.ackdconsult.com

Riyadh, Saudi Arabia

ACKD

TABLE OF CONTENT

01

Supervision & Project Management

GALLERY OF PROJECTS

Our experience includes many types of occupancies and buildings:

1

Entertainment

2

Industrial

3

Commercial

4

Residential

5

Educational

6

Health care

7

High-Rise

WE ARE SPECIALIZED AT

1

Review of drawings and specifications.

2

Supervision inspection.

3

Approval of materials

4

Review and approval of contractors' invoices.

5

Make weekly and monthly reports for client .

6

Submit the required reports for AMANA & WAFI.

Real Estate Developer :



Fund Manager :



بلوم إنفست
BLOMINVEST

KING FAHAD TOWER

Olaya Street Riyadh

Design Review.

Construction Supervision.

Project Documentation and Reporting:

Achieving the targeted level of quality for the project.

Controlling the project budget.

Completing the project within the specified timeframe.

Client: Almashari Aloula

www.ackdconsult.com

Riyadh, Saudi Arabia

ACKD

Real Estate Developer :



Nawa Tower

Riyadh

Design Review.

Construction Supervision.

Project Documentation and Reporting:

www.ackdconsult.com

Riyadh, Saudi Arabia

Achieving the targeted level of quality for the project.

Controlling the project budget.

Completing the project within the specified timeframe.

Client: Nawa Real Estate

ACKD

Real Estate Developer :

عنات
ANAN

Fund Manager :

واقصي

Anan Real Estate Residential Tower

3 basements, 27 floor levels

Land Area: 900 m²

Design Review.

Construction Supervision.

Project Documentation and Reporting:

Achieving the targeted level of quality for the project.

Controlling the project budget.

Completing the project within the specified timeframe.

www.ackdconsult.com

Riyadh, Saudi Arabia

ACKD

Fund Manager :



بلوم انفست
BLOMINVEST

Operator :



HYATT
REGENCY

Sahafa Tower

4 basements, 28 floor levels , Roof

Land Area: 1800m²

www.ackdconsult.com

Riyadh, Saudi Arabia

ACKD

Real Estate Developer :



Supervision of Commercial-residential Building

4 basements, 20 floor levels , Roof

Land Area: 2450 m²

www.ackdconsult.com

Riyadh, Saudi Arabia

ACKD

Real Estate Developer :

Abdulaziz Al Dhiab & Brothers
عبد العزيز الذياب واخوانه

Al-Thiyab Tower

Riyadh

Design Review.

Project Management Consultant.

Client: Abdulaziz Althiyab Company

www.ackdconsult.com

Riyadh, Saudi Arabia

ACKD

Real Estate Developer :



كلمة للتطوير والاستثمار العقاري
Kelma Real Estate Investment & Development

Kalima Tower

Riyadh

Design Review.

Project Management Consultant.

Client: Kalima Real Estate Development

www.ackdconsult.com

Riyadh, Saudi Arabia

ACKD

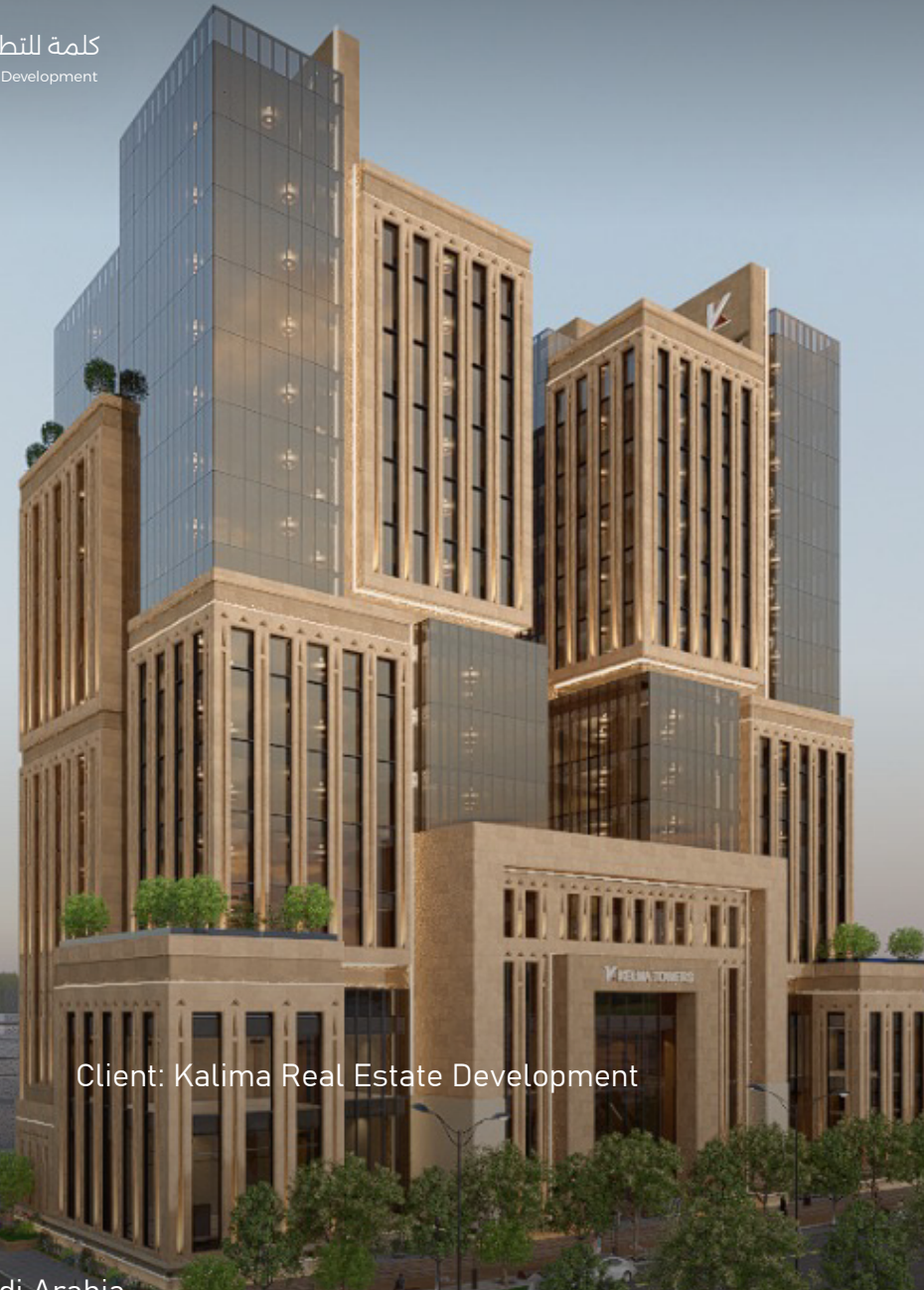

Real Estate Developer :



Fund Manager :



Palms Tower

Riyadh

Supervision
reporting wafi

www.ackdconsult.com

Riyadh, Saudi Arabia

ACKD



Real Estate Developer :
أراماك
ARAMAK
العقارية REAL ESTATE

Operator :
MARRIOTT
Sheraton

Fund Manager :
الراجحي المالية
alrajhi capital

Aramak Real Estate Mixed- Use Development

Land Area : 40,000 m²

Design Review.
Construction Supervision.
Project Documentation and Reporting:

Achieving the targeted level of quality for the project.
Controlling the project budget.
Completing the project within the specified timeframe.

www.ackdconsult.com

Riyadh, Saudi Arabia

ACKD

Real Estate Developer :



Owner :

وقف عبدالله بن عبدالعزيز آل سعود
ABDULLAH BIN ABDULAZIZ AL-RAJHI ENDOWMENT



Officers District Hotel

Land Area: 48000 m²

www.ackdconsult.com

Riyadh, Saudi Arabia

ACKD

Real Estate Developer :



Owner :



Officers District Hotel

Land Area: 10000 m2

www.ackdconsult.com

Riyadh, Saudi Arabia

ACKD

Real Estate Developer :



Fund Manager :



Supervision of residential Building

Land Area: 7732 m²

www.ackdconsult.com

Riyadh, Saudi Arabia

ACKD

Real Estate Developer :



Fund Manager :



Al-Yasmin Villas

20 Villa

Client: Almashari Aloula

Location: Alyasmin Destrict

Status: Finished

SOW: Supervision

www.ackdconsult.com

Riyadh, Saudi Arabia

ACKD

Mohammed bin Sulaiman Al Habib Real Estate
Real Estate Developer : محمد بن سليمان الحبيب العقارية

Hayaz Project

Residential Villas located in Riyadh KSA Total Built up area = 13,500 m2 16 residential villas and 9 residential buildings.

Design .
Project Management Consultant.

www.ackdconsult.com

Riyadh, Saudi Arabia

ACKD

Real Estate Developer :  IQ Real Estate
آي كيو العقارية

Fund Manager :  وافي

Masharef Hills Villas

19 Villa

Client: IQ Real Estate
Location: Narjes Destrict

Status: Finished
SOW: Design & Supervision

www.ackdconsult.com

Riyadh, Saudi Arabia

ACKD

Real Estate Developer :



Fund Manager :

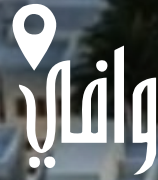

Al-Mohamadiah (2,3) Villas

21 Villa

Client: Almashari Aloula

Location: Almohamdiah District

Status: Finished

SOW: Supervision

www.ackdconsult.com

Riyadh, Saudi Arabia

ACKD

Real Estate Developer :



IQ Real Estate
آي كيو العقارية

Adwar Tanal

20 villas _ 60 floors

Land Area = 8120

Design Review.

Construction Supervision.

Project Documentation and Reporting:

Achieving the targeted level of quality for the project.

Controlling the project budget.

Completing the project within the specified timeframe.

www.ackdconsult.com

Riyadh, Saudi Arabia

ACKD

Real Estate Developer :



Fund Manager :



Qurtubah Villas Project

Riyadh

Design Review.

Project Management Consultant.

Client: Almashari Aloula

www.ackdconsult.com

Riyadh, Saudi Arabia

ACKD

Project B1578 | Commercial Office Building

Riyadh
Design Review.
Project Management Consultant.

Client: Raven Real Estate



Real Estate Developer :



Al-Ma'alem Park

Project Area: 28,000 sqm

Number of Floors: Basement + 4 Floors

Client: Ajbál Real Estate Development

Design Review.

Construction Supervision.

Project Documentation and Reporting:

Achieving the targeted level of quality for the project.

Controlling the project budget.

Completing the project within the specified timeframe.

Real Estate Developer :

أجبال
AJBAL

Al-Zuhour Park

Project Area: 20,000 sqm

Number of Floors: Basement + 3 Floors

Client: Ajbale Real Estate Development

Design Review.

Construction Supervision.

Project Documentation and Reporting:

Achieving the targeted level of quality for the project.

Controlling the project budget.

Completing the project within the specified timeframe.

www.ackdconsult.com

Riyadh, Saudi Arabia

ACKD

THANK YOU

CONTACT INFO

ACKD scope of work

Website www.ackdconsult.com

Email info@Ackdconsult.net

Phone +966 56 666 0960
011 2167333

Riyadh, Saudi Arabia

Prince Mohammed Ibn Salman Ibn Abdulaziz Rd

First Floor - Office 20